

Ficha técnica

Description:

HK-100 swing welding trolley is automatic. It can gain more wide welded seam at a time. You can adjust swing speed, swing angle, offset position of centre and length of stay. It suits for vary specs beads. In non-welding state, the biggest trolley speed is 1300mm/min. The magnetron hand grip can decrease a few magnetism, so it is convenient to clear iron waste and moving trolley.

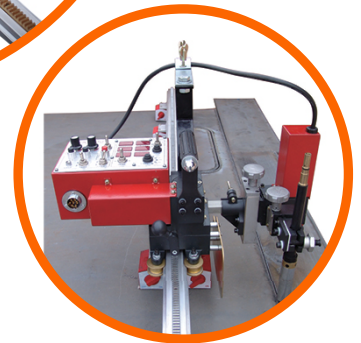
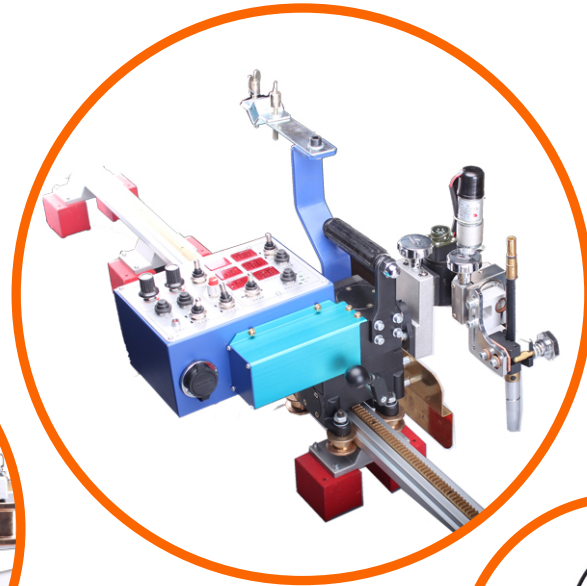
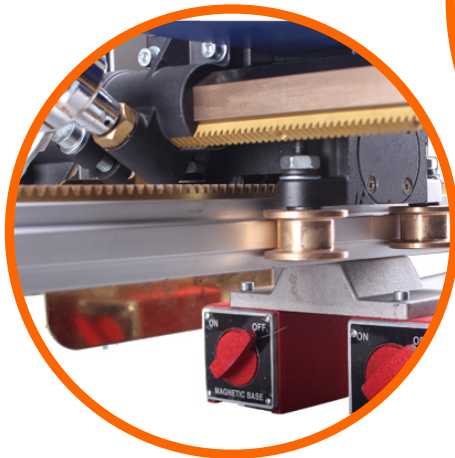

Product function:

The from NXT-100 small car essence, the control box, the X-Y slippery piece, the gun tongs, the direction round, leads a track straightly etc. the parts constitute.

- 1. Little car owner's body:** Be also a small car to drive device, include electrical engineering, the planet decelerates a box, driving wheel gear and leading to an etc.
- 2. Control a box:** Can regulate all actions of the small car, the detailed contents makes reference to follow-up "the control panel elucidation".
- 3. The Horizontal move device:** the Be welding to keep to sew (the if gather to pack) to make use of this device to adjust the torch position, avoid multifariously ambulation leading a track.
- 4. The torch is tiny to adjust a slippery piece:** Be the device that regulates the gun position, weld in the middle can carry on a top and bottom or so tiny adjust.
- 5. Swing a machine:** Weld process in various weld mode to need him to carry out.
The gun clips to hold a machine: Be the device of the fixed gun, maintain and the adjustment is a convenient gun to dismantle to unload. The torch must clip tightly, notice and clip Be conducting electricity part, then will cause short-circuit or electric shock.
- 6. AC outlet:** In order to circumscribe the electric cable electric outlet, this the machine connects a ground of line to also connect with each other with this electric outlet. This electric cable electric outlet is responsible for a small car and sends the conjunction and the electricity supply of the silk machine. (Electric cable of another on carrying two branches, a connects to send the silk machine, the another connects power supply.)

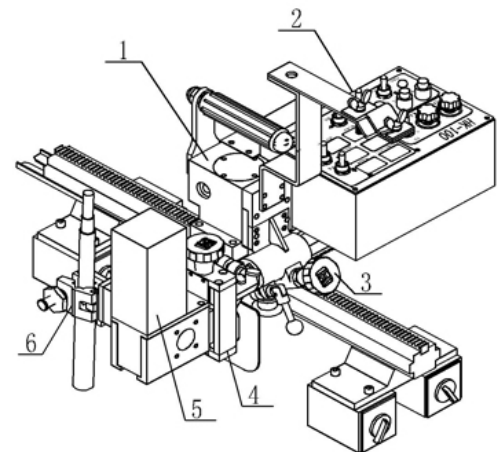

Place of Origin: China

Ficha técnica

Product function:

The from NXT-100 small car essence, the control box, the X-Y slippery piece, the gun tongs, the direction round, leads a track straightly etc. the parts constitute.

- 8. Hand handle:** The ambulation equips originally, please fist this hand handle.
- 9.** Leaving to match the hand handle, pulling to move this hand handle can let very conveniently the small car move freely on the orbit.
- 10. Lead a track straightly:** The convenient and small car runs about route. The gearing has strong dint always the magnetic iron, letting to lead a track to adsorb the work piece firmly on, the orientation is various to weld a need.
- 11. The Magnetic iron:** The strong dint leaves the match type magnetic iron, the please control all the switch to go to "OFF" while moving to lead a track.
- 12. Lead to a round:** Along the female material noodles roll over, guide accurate weld the device of the part.
- 13. The Gun:** the Keep the gun or curved gun, the customer make choice of purchase.

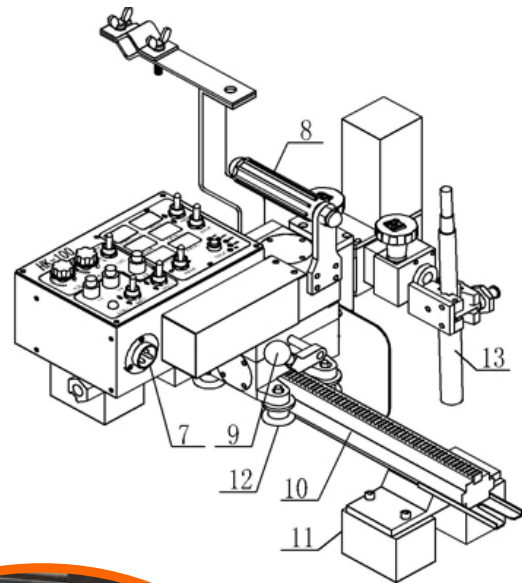

Ficha técnica

Technical Specification:

Weight	Outline dimension	Driving mode	Power	Swing motor	Speed	Tracking mode
8.4Kg (Included swing device)	430 mm x 280 mm x 290 mm	Four rims driving (Rubber rim)	DC 24V	DC 24V	30~800 (mm/min) (Display by nixie tube)	Rail

Range of adjusting welding torch	Operation function		Choose swing model
Up and down : 40mm Front and rear : 60mm. Range of working angle : $\pm 45^\circ$ Range of adjusting angle: 10°	Choose walk direction : Left and right Swing speed : 0~100 Swing angle : $\pm 15^\circ$	Adjust walk speed : 0~130cm/min Length of stay on left or right : 0~2.5 s Set position of deviation : $0 \sim \pm 8^\circ$	

Welding technical parameters

welding wire diameter welding parameter	current (A)			voltage (U)	distance between nozzle and workpiece (H)	welding extension length (L)
	Down hand welding	flush fillet welding	horizontal welding			
$\Phi 1.2\text{mm}$	120-300	120-280	120-280	U=14+0.051 300A under U=0.041+16 \pm 1.50 above 300A U=0.041+20 \pm 2.0	Below 200A: H=10~15mm 200~350A H=15~20mm 350~500A H=20~25mm	The length is about 10 times welding wire diameter. It is L=10d
$\Phi 1.4\text{mm}$	150-380	150-320	150-300			
$\Phi 1.6\text{mm}$	180-430	180-380	180-330			