

**MX7**  
CUTTING SYSTEMS



**CATALOG**

**CNC** | CUTTING  
TABLES



# ECONOCUT



## ● Main components

- A good choice for flame and plasma cutting. It is specially designed for metal plate cutting process.
- Machine size can be produce due to customer's requirement on X and Y direction.
- Strong gantry system ensures durability, stability and quick speed. CNC controller gives screen of 7", English, Russian, Spanish and others.
- CNC Controller gives easy operation interface, shape library and cutting parameters programs.
- Efficiency improvement and cutting quality functions, including Mirror, rotation, scale, repeat, etc USB terminal is to supporting program and data inputing and outputing.
- Automatic torch height controller on flame and plasma torches.
- With Auto ignition device on flame torch flash arrestor on flame torch.
- For light industries requesting ordinary thickness by both plasma and flame.

## ● Specification

Model	ECONOCUT
Input Voltage(V)	110/220/230/240V, 220/380/400/415V, 50/60HZ
Rail distance (mm)	2500/3000/3500/4000
Effective cutting width(mm)	600mm less than rail distance
Rail length(mm)	Customer' s requirement or 6000,8000,10000,12000
Effective cutting length(mm)	1500mm less than rail length
CNC torch (piece)	1-2
Flame cutting thickness (mm)	6-150
Flame cutting speed (mm/min)	50-750
Moving speed (mm/min)	12000
Flame cutting gas	Acetylene, Propane, LPG
Plasma cutting thickness (mm)	Due to plasma power source
Plasma power source	Suits Hypertherm Powermax45 65 85 105 125



Working process



**Option 1**  
Controllers

Standard: HG616, 10" monitor

Upgrade: stand alone CNC, 17" monitor

**Option 2**  
Plasma unit

Powermax series

Maxpro200

**Option 3**  
Nesting software

Standard: FastCAM

Upgrade: Libellula

Upgrade: ProNest2017 LTS

**Option 4**  
Torch Height controller

Standard torch lifter

Upgrade: separate lifter

**Option 5**  
Machine at sites





Hypertherm power source	Material	Quality cutting	Pierce thickness	From edge	Victor	Kjellburg
POWERMAX45	Mild steel	6mm	10mm	25mm	CUTMASTER40	N/A
	Stainless steel	6mm	10mm	19mm		
	Aluminium	6mm	10mm	19mm		
POWERMAX65	Mild steel	8mm	12mm	25mm	CUTMASTER60	N/A
	Stainless steel	8mm	12mm	20mm		
	Aluminium	8mm	12mm	20mm		
POWERMAX85	Mild steel	10mm	16mm	30mm	CUTMASTER80	N/A
	Stainless steel	10mm	16mm	25mm		
	Aluminium	10mm	16mm	25mm		
POWERMAX105	Mild steel	14mm	22mm	38mm	CUTMASTER100	N/A
	Stainless steel	12mm	19mm	32mm		
	Aluminium	12mm	19mm	32mm		
POWERMAX125	Mild steel	16mm	25mm	44mm	CUTMASTER120	N/A
	Stainless steel	16mm	25mm	44mm		
	Aluminium	16mm	25mm	44mm		
MAXPRO 200	Mild steel	20mm	32mm	75mm	AUTOCUT200	N/A
	Stainless steel	20mm	25mm	64mm	AUTOCUT300	
	Aluminium	20mm	32mm	75mm		
HPR130XD	Mild steel	16mm	32mm	38mm	ULTRACUT200	SmartFocus200
	Stainless steel	16mm	20mm	25mm		
	Aluminium	16mm	20mm	25mm		
HPR260XD	Mild steel	32mm	38mm	64mm	ULTRACUT300	SmartFocus300
	Stainless steel	32mm	32mm	50mm		
	Aluminium	32mm	25mm	50mm		
XPR300	Mild steel	35mm	50mm	80mm	ULTRACUT300	SmartFocus300
	Stainless steel	32mm	38mm	75mm		
	Aluminium	32mm	38mm	50mm		
HPR400XD	Mild steel	38mm	50mm	80mm	ULTRACUT400	SmartFocus400
	Stainless steel	38mm	45mm	80mm		
	Aluminium	38mm	45mm	80mm		
HPR800XD	Mild steel	38mm	50mm	80mm	N/A	HiFocus600i
	Stainless steel	75mm	75mm	160mm		
	Aluminium	75mm	75mm	160mm		





## Powermax45

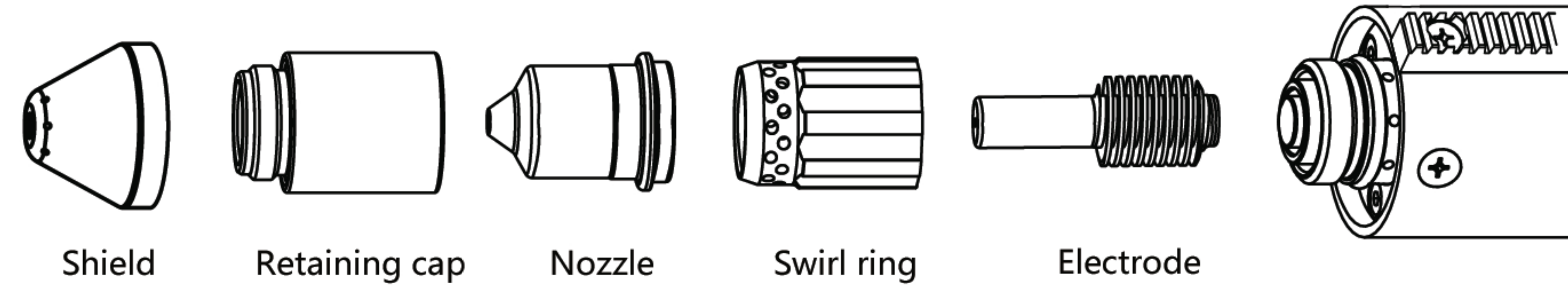
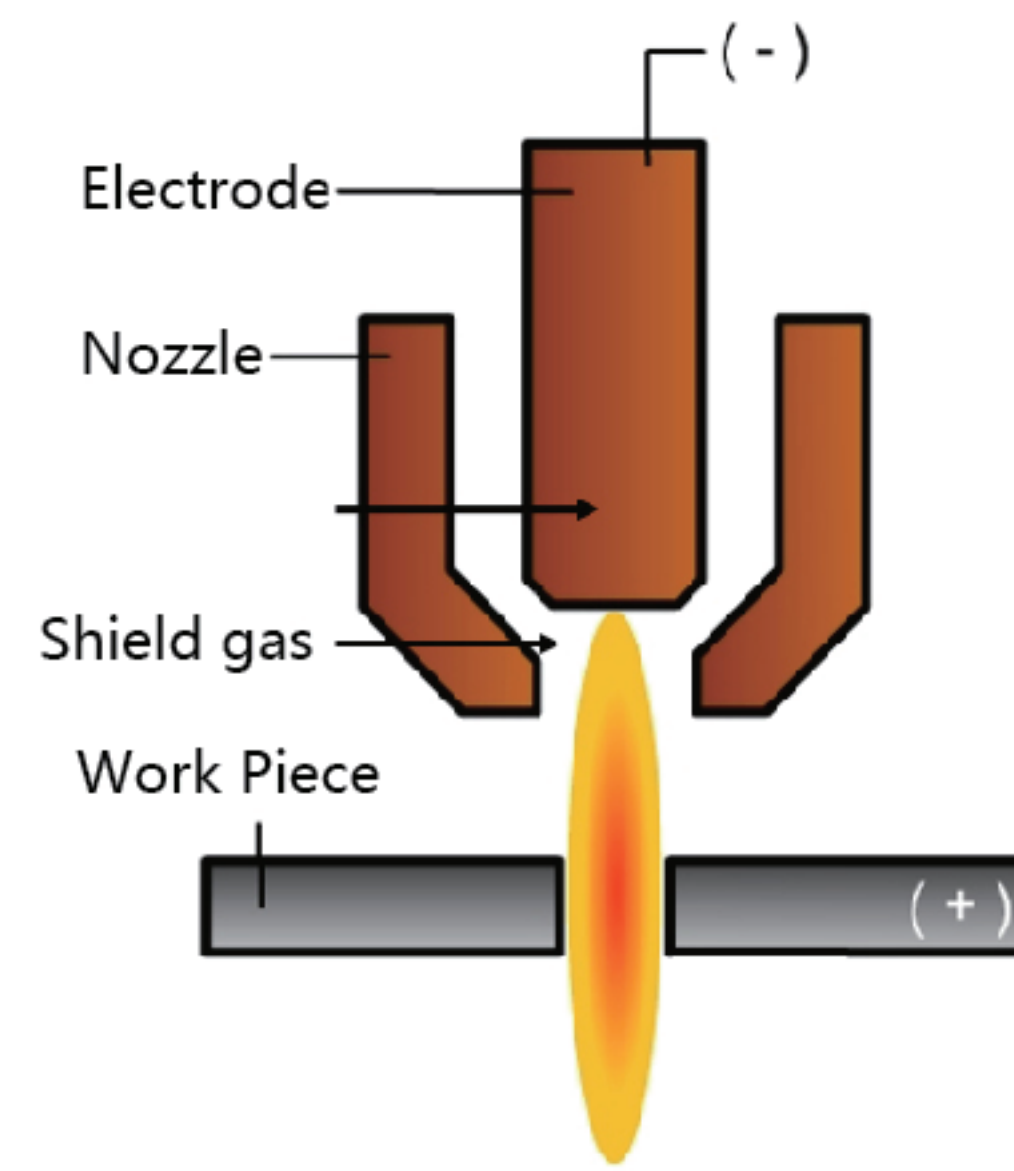

Specs	Thickness(mm)	"Shield/Deflector Life time (h)"	"Retaining cap Life time (h)"	"Nozzle /Life time (h)"	"Swirl ring Life time (h)"	"Electrode Life time (h)"	Auxiliary gas Air/Air
45A	1mm~10mm	220673 (32 hour)	220713 (960 hour)	220671 (6 hour)	220670 (720 hour)	220669 (6 hour)	Air/Argon
10A	0.1mm	420542 (32 hour)	220854 (960 hour)	420415 (6 hour)	220857 (720 hour)	220842 (6 hour)	

## Powermax65

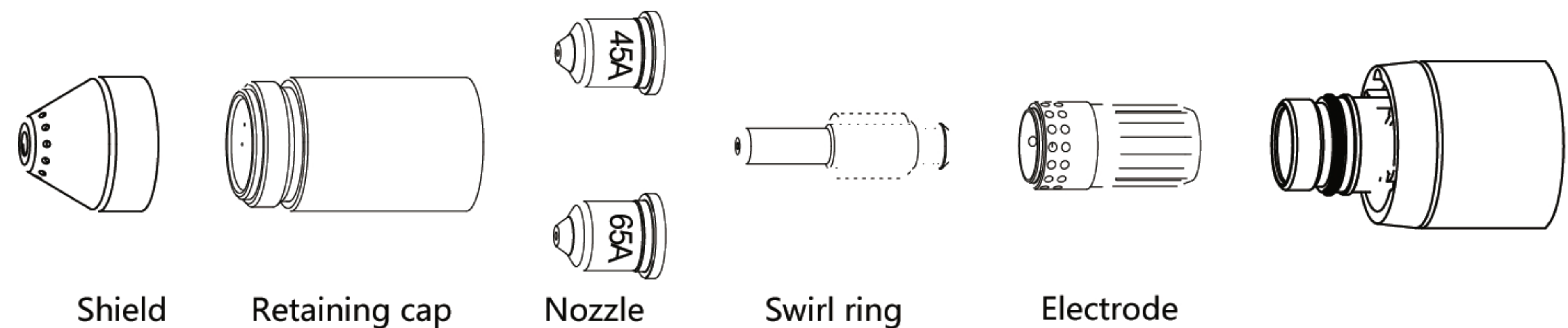
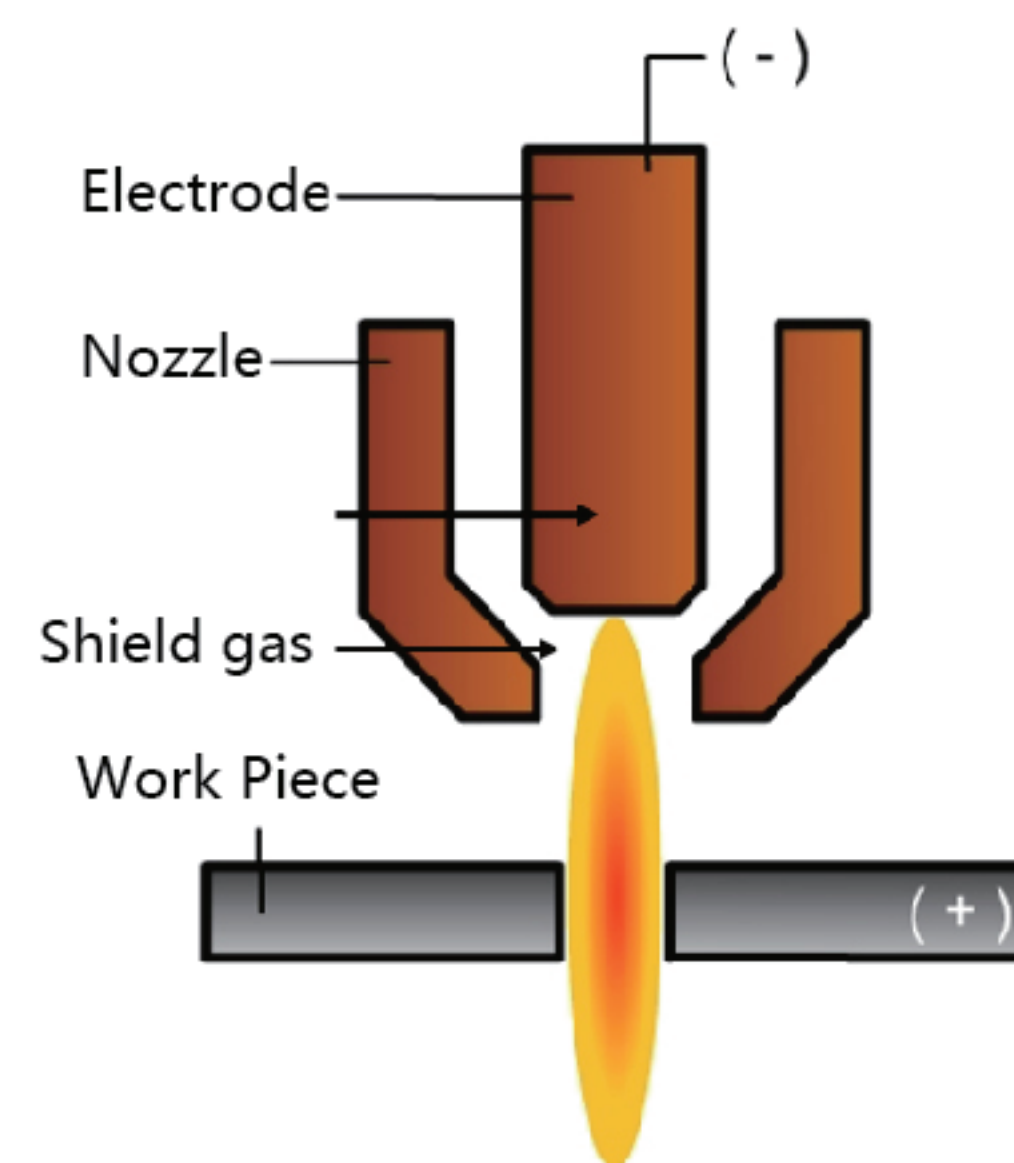

Specs	Thickness(mm)	"Shield/Deflector Life time (h)"	"Retaining cap Life time (h)"	"Nozzle /Life time (h)"	"Swirl ring Life time (h)"	"Electrode Life time (h)"	Auxiliary gas
45A	1mm-6mm	220817 (32 hour)	220854 (960 hour)	220941 (6 hour)	220857 (720 hour)	220842 (6 hour)	Air/Air
65A	2mm-16mm	220817 (32 hour)	220854 (960 hour)	220819 (6 hour)	220857 (720 hour)	220842 (6 hour)	Air/Air
Fine cut	0.5mm-4mm	220948 (32 hour)	220953 (960 hour)	220930 (6 hour)	220842 (720 hour)	220857 (6 hour)	Air/Air

## Powermax85

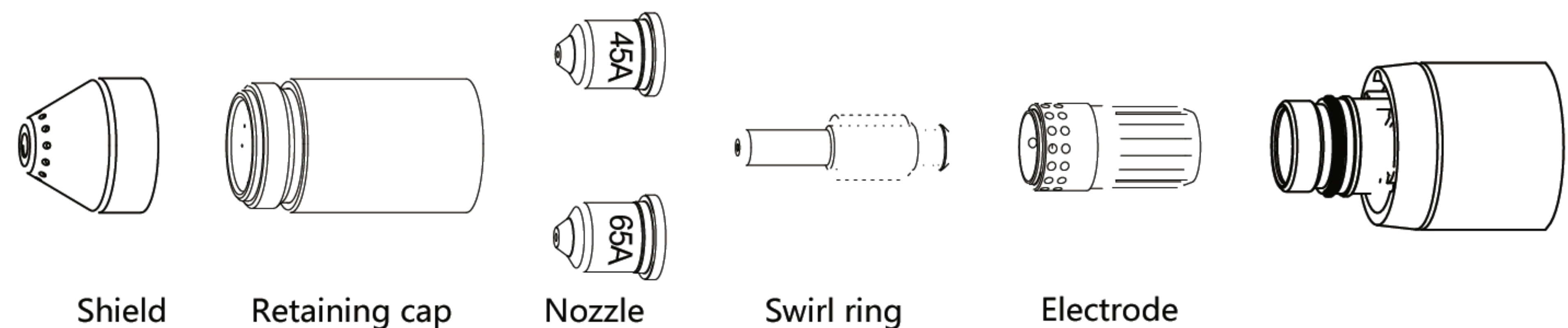
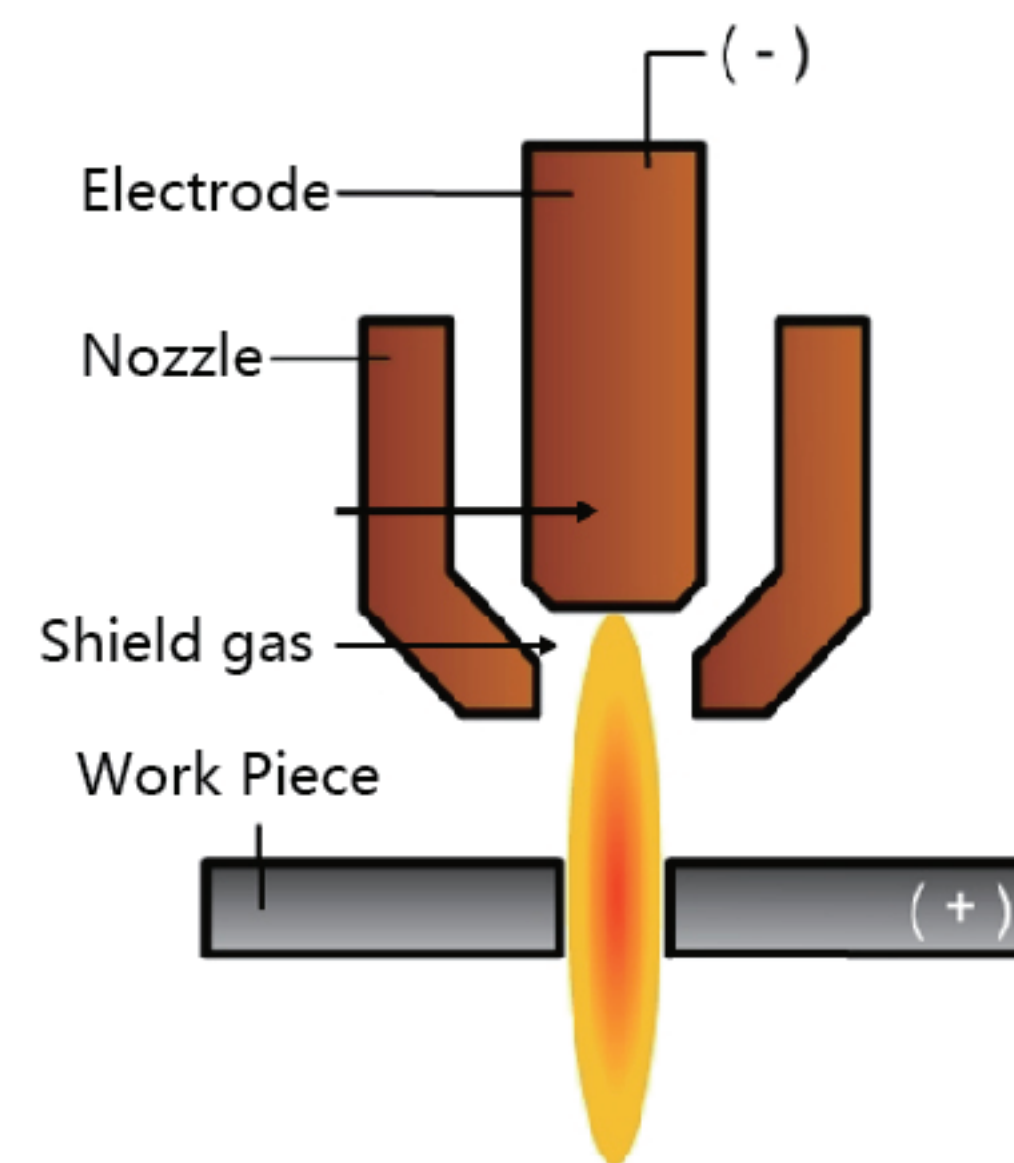

Specs	Thickness(mm)	"Shield/Deflector Life time (h)"	"Retaining cap Life time (h)"	"Nozzle /Life time (h)"	"Swirl ring Life time (h)"	"Electrode Life time (h)"	Auxiliary gas
45A	1mm-6mm	220817 (32 hour)	220854 (960 hour)	220941 (6 hour)	220857 (720 hour)	220842 (6 hour)	Air/Air
65A	2mm-16mm	220817 (32 hour)	220854 (960 hour)	220819 (6 hour)	220857 (720 hour)	220842 (6 hour)	Air/Air
85A	3mm-18mm	220817 (32 hour)	220854 (960 hour)	220816 (6 hour)	220857 (720 hour)	220842 (6 hour)	Air/Air
Fine cut	0.5mm-4mm	220948 (32 hour)	220953 (960 hour)	220930 (6 hour)	220842 (720 hour)	220857 (6 hour)	Air/Air





# Powermax105

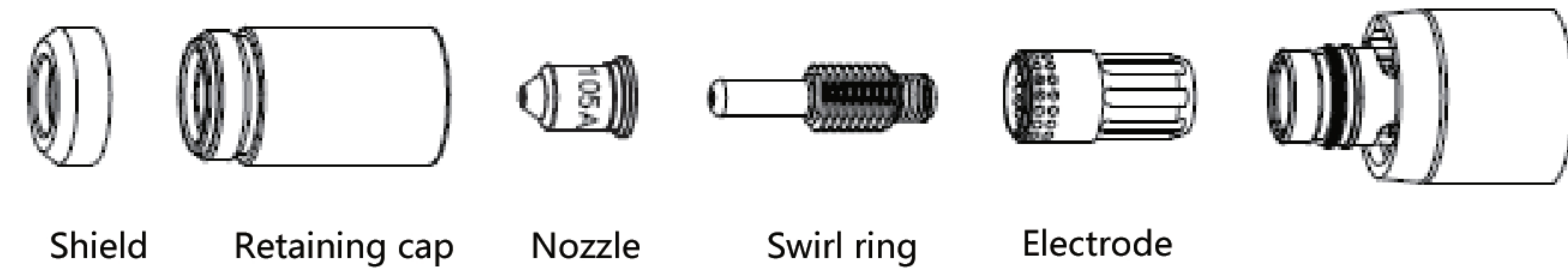
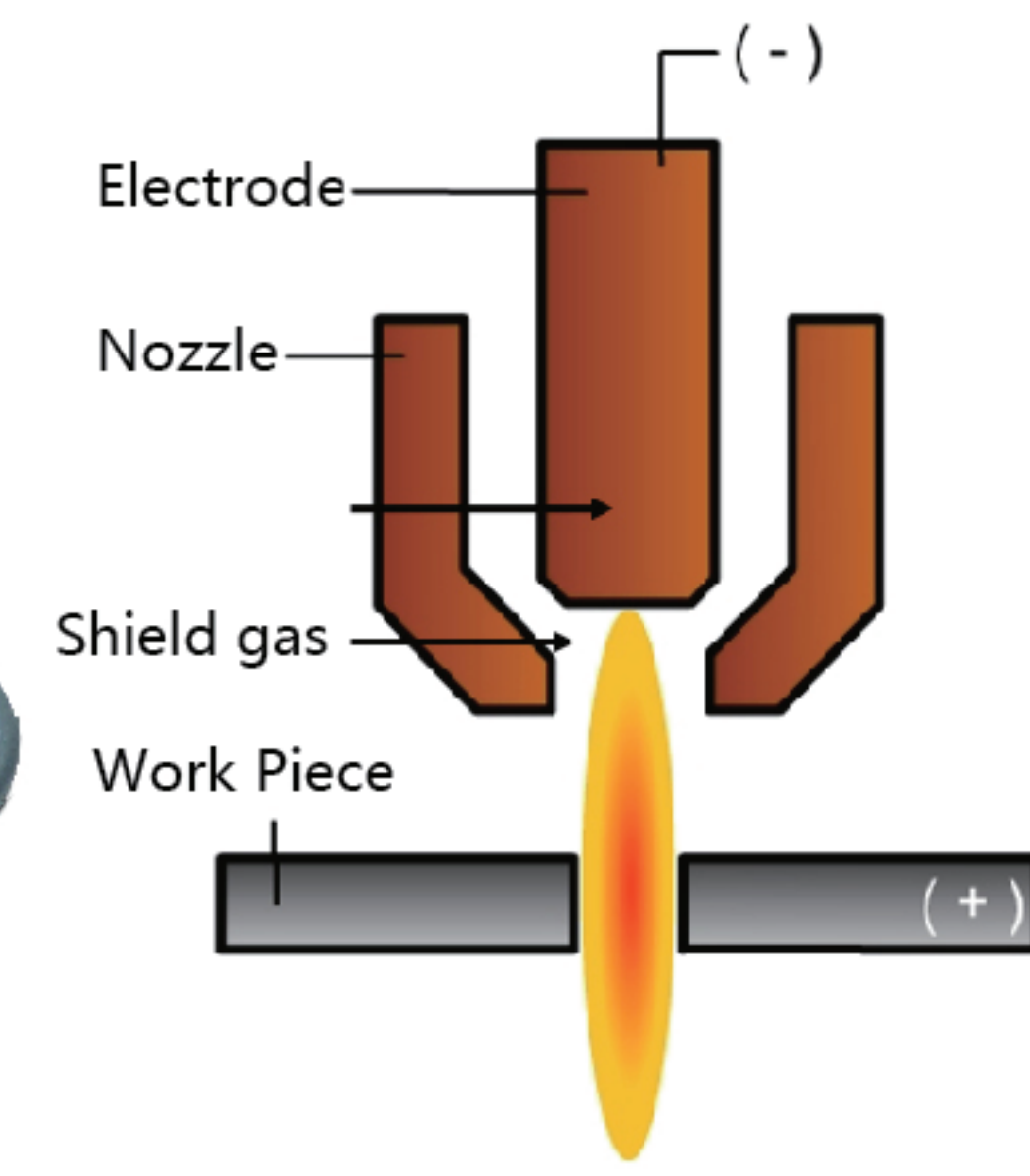

Specs	Thickness(mm)	"Shield/Deflector Life time (h)"	"Retaining cap Life time (h)"	"Nozzle /Life time (h)"	"Swirl ring Life time (h)"	"Electrode Life time (h)"	Auxiliary gas
45A	0.5mm-6mm	220817 (35 hour)	220854 (960 hour)	220941 (5 hour)	220994 (720 hour)	220842 (5 hour)	Air/Air
65A	2mm-16mm	220817 (35 hour)	220854 (960 hour)	220819 (5 hour)	220994 (720 hour)	220842 (5 hour)	Air/Air
85A	3mm-18mm	220817 (35 hour)	220854 (960 hour)	220816 (5 hour)	220994 (720 hour)	220842 (5 hour)	Air/Air
105A	6mm-20mm	220993 (35 hour)	220854 (960 hour)	220990 (5 hour)	220994 (720 hour)	220842 (5 hour)	Air/Air
Finecut	0.5mm-4mm	220948 (35 hour)	220953 (1440 hour)	220930 (4 hour)	220994 (720 hour)	220842 (4 hour)	Air/Air

# Powermax125

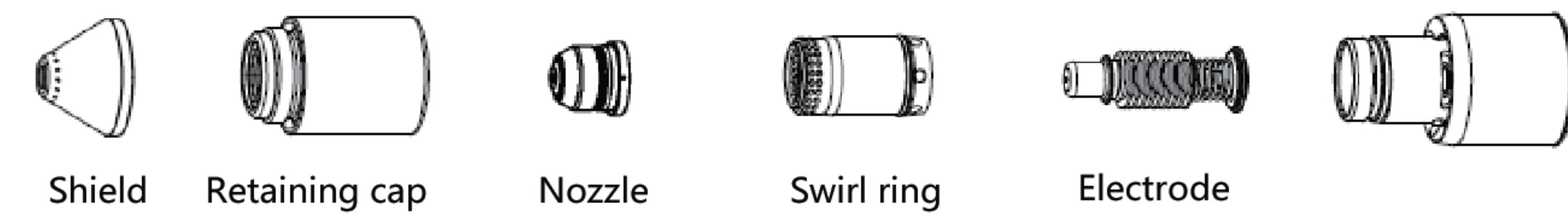
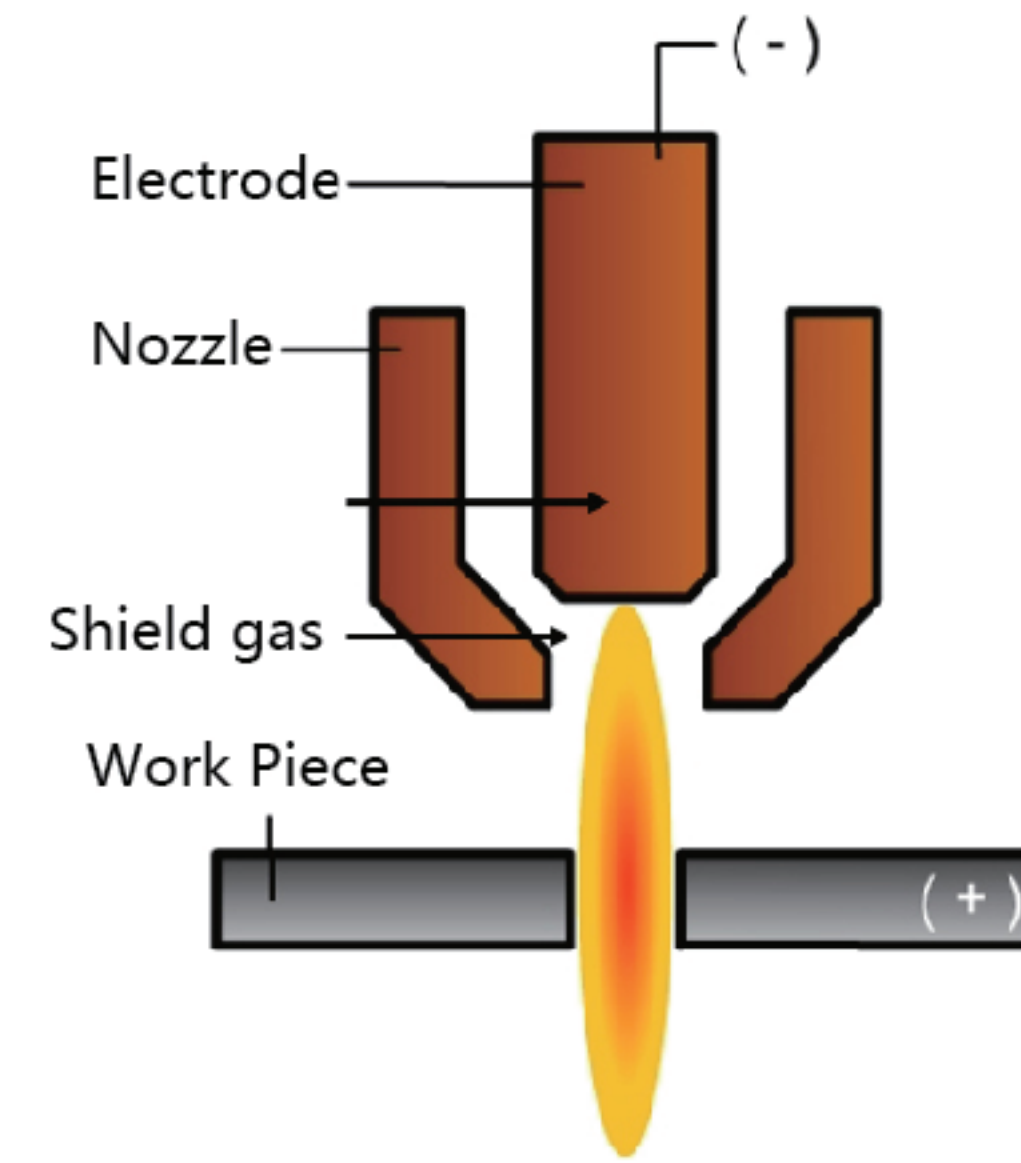

Specs	Thickness(mm)	"Shield/Deflector Life time (h)"	"Retaining cap Life time (h)"	"Nozzle /Life time (h)"	"Swirl ring Life time (h)"	"Electrode Life time (h)"	Auxiliary gas
45A	1mm-6mm	420168 (35 hour)	220977 (1440 hour)	420158 (5 hour)	220997 (720 hour)	220971 (5 hour)	Air/Air
65A	2mm-8mm	420168 (35 hour)	220977 (1440 hour)	420169 (5 hour)	220997 (720 hour)	220971 (5 hour)	Air/Air
105A	6mm-20mm	220976 (35 hour)	220977 (1440 hour)	220975 (5 hour)	220997 (720 hour)	220971 (5 hour)	Air/Air
125A	6mm-25mm	220976 (35 hour)	220977 (1440 hour)	220975 (4 hour)	220997 (720 hour)	220971 (4 hour)	Air/Air
Finecut	0.5mm-4mm	420152 (35 hour)	220977 (1440 hour)	420151 (4 hour)	420159 (720 hour)	220971 (4 hour)	Air/Air

# MAXPRO200

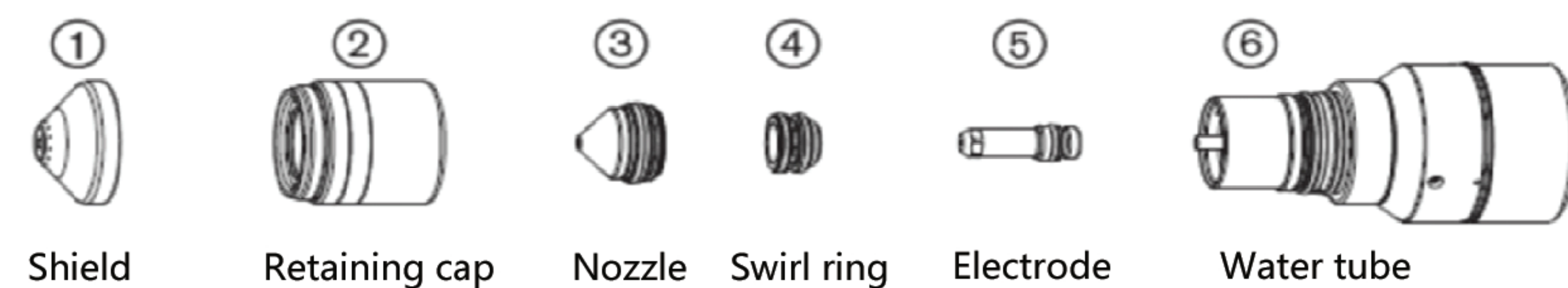
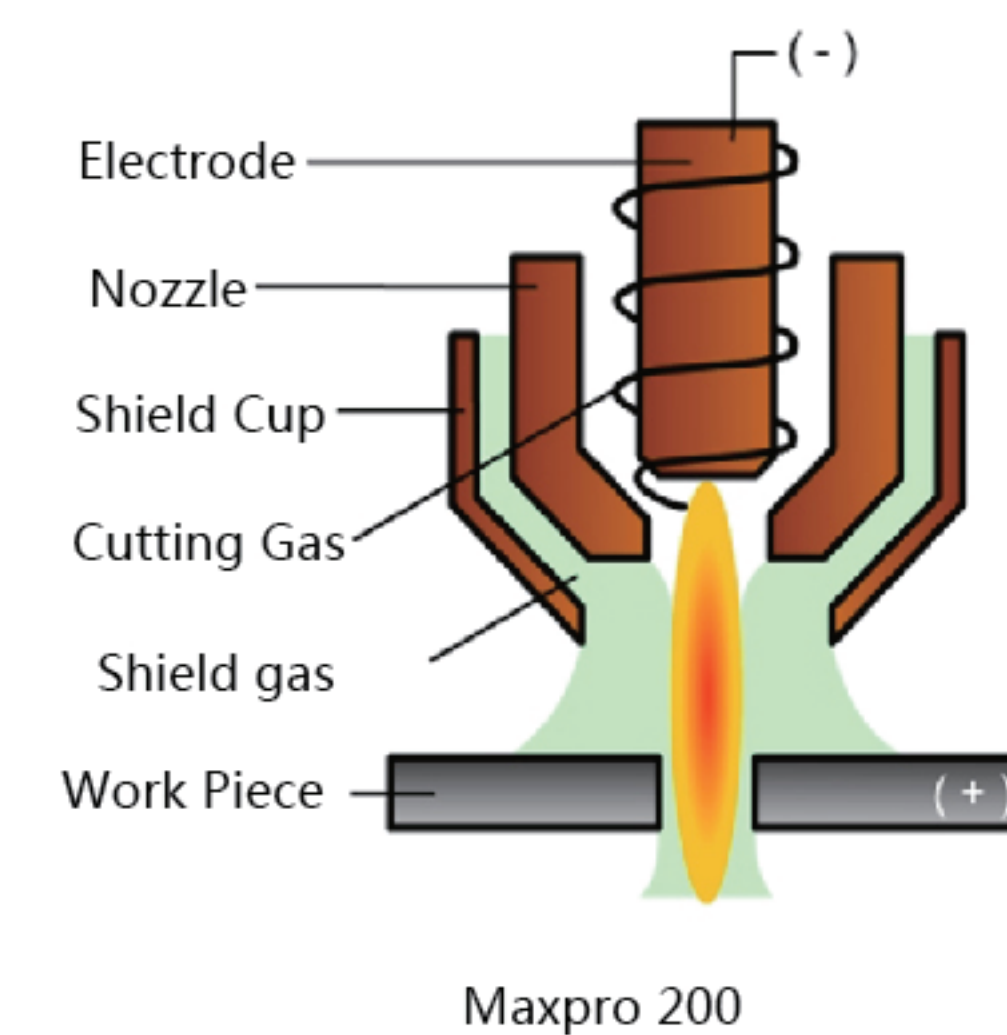

Specs	Thickness(mm)	"Shield/Deflector Life time (h)"	"Retaining cap Life time (h)"	"Nozzle /Life time (h)"	"Swirl ring Life time (h)"	"Electrode Life time (h)"	"Water tube Life time (h)"	Auxiliary gas
50A	0.5mm-6mm	220532 (40 hour)	220935 (800 hour)	220890 (5.5 hour)	220529 (240 hour)	220528 (5.5 hour)	220521 (2400 hour)	Air/Air
50A	0.5mm-6mm	220532 (40 hour)	220935 (800 hour)	220891 (5.5 hour)	220529 (240 hour)	220528 (5.5 hour)	220521 (2400 hour)	O2/Air
130A	3mm-32mm	220536 (40 hour)	220935 (800 hour)	220892 (5.5 hour)	220488 (240 hour)	220487 (5.5 hour)	220521 (2400 hour)	Air/Air
130A	3mm-38mm	220491 (40 hour)	220935 (800 hour)	220893 (5.5 hour)	220488 (240 hour)	220487 (5.5 hour)	220521 (2400 hour)	O2/Air
130A	5mm-20mm	220536 (40 hour)	220935 (800 hour)	220892 (5.5 hour)	220529 (240 hour)	020415 (5.5 hour)	220521 (2400 hour)	N2/N2
200A	6mm-50mm	420045 (40 hour)	220935 (800 hour)	420044 (5.5 hour)	220488 (240 hour)	220937 (5.5 hour)	220521 (2400 hour)	Air/Air
200A	6mm-50mm	220832 (40 hour)	220935 (800 hour)	220831 (5.5 hour)	220834 (240 hour)	220937 (5.5 hour)	220521 (2400 hour)	O2/Air
200A	5mm-38mm	420045 (40 hour)	220935 (800 hour)	420044 (5.5 hour)	220529 (240 hour)	020415 (5.5 hour)	220521 (2400 hour)	N2/N2



THE NEXT GENERATION OF CUTTING TOOLS



CONTACT

PHONE

(55) 4352 0183

E MAIL

[contacto@tesyc.mx](mailto:contacto@tesyc.mx)

WEB

[www.mundo-plasma.com](http://www.mundo-plasma.com)

WE ARE EXPERTS IN CUTTING